



YOUNG DRIVER'S GUIDE

Tips on How to Survive
Nevada's Roads



EMERGENCY CONTACTS



**For Roadside Emergencies
— Dial 911 —**

**For Roadside Emergencies
— Dial 911 —**

Nevada Highway Patrol (dial*NHP)

Clark County School District Police Department: **702-799-5411**
Washoe County School District Police Department: **775-348-0285**
Elko County School District Police Department: **775-777-7300**

Washoe County School District Police Department: **775-348-0285**
Elko County School District Police Department: **775-777-7300**

Elko County School District Police Department: **775-777-7300**

LOCAL AUTHORITIES

PERSONAL CONTACTS

[illegible]

GLOVE BOX CHECKLIST



1

Registration



2

Proof of Insurance



3

Owner's Manual



4

Pen and Paper



SUPPLY CHECKLIST

☐

Spare Tire, Jack
& Tire Iron

☐

Jumper Cables

☐

Tire Pressure
Gauge

☐

Duct Tape

☐

First Aid Kit

☐

Flashlight

☐

Multi-Tool

☐

Blanket

☐

Energy Bar
(Snacks)

☐

Water

☐

Reflective
Triangles

☐

Ice Scraper &
Snow Chains

If Applicable



HOW TO CHECK TIRE TREAD



→ You Need New Tires

→ Tires Are Fine

The right amount of tread will keep you safe by helping your tires grip the road and allowing water to escape during wet weather.



Remember to keep your tires at the appropriate pressure level for safe traveling. Check your owner's manual for your specific PSI.



WHAT TO DO IF YOU HAVE A FLAT TIRE

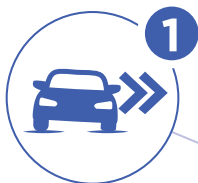

Pull to the side of the road as cautiously and as far over as possible. If you exit your car, do so on the side opposite of traffic.

Apply your parking brake and turn on your hazard lights.



Consult your owner's manual and follow the manufacturer's instructions for properly locating your spare tire, jack and tire iron.



HOW TO JUMP START A CAR

Begin with both cars off.

- 1 **Red** on Dead +
- 2 **Red** on Donor +
- 3 **Black** on Donor -
- 4 **Black** on Bare Metal
This grounds the cable to avoid shock
- 5 **Start Donor**
- 6 **Start Dead**
- 7 **Remove 4 - 3 - 2 - 1**

When you get your car started, let it run for at least 15 minutes to recharge the battery. Replace the battery if it fails to start again.

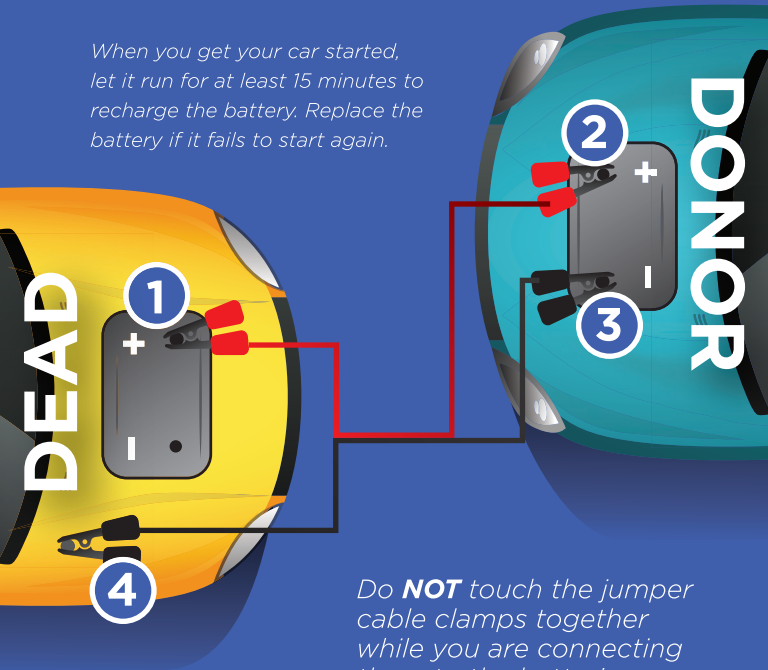

*Do **NOT** touch the jumper cable clamps together while you are connecting them to the batteries.*

7

MAJOR CAR COMPONENTS AND HOW OFTEN TO CHECK THEM

1

Motor Oil



Check once per month or every time you fill up with gas

2

Brake Fluid



Check every time you get your oil changed

3

Coolant



Check at least 2 times per year (once before summer and again before winter)

4

Transmission Fluid



Check every time you get your oil changed (needs to be replaced every 50,000 - 100,000 miles)

5

Windshield Wiper Fluid



Check once per month

6

Power Steering Fluid



Check every time you get your oil changed

7

Check Battery



Most batteries have a long shelf life, but you should still keep an eye on them (most need to be changed every 3-5 years)



STAY SAFE. STAY ALIVE.



Always Buckle Up



Always Drive Sober



Focus on the Road



Slow Down



Keep Your Cool

For more information about our
Cars & Cops program visit

ZeroTeenFatalities.com



Funding provided in whole by the Nevada Office of Traffic Safety