

DAVIS COUNTY



MEETING / PLANNING / ACTIVITIES GUIDE



Where work meets play

Minutes from the Salt Lake City International Airport and downtown Salt Lake area, Davis County is a prime destination for meeting planners and event organizers. It offers convention and meeting space for any type of activity. Nationally branded hotels and restaurants surround the Davis Conference Center, making Davis County the ideal place to meet, eat, stay and play.

Choosing Davis County as your convention destination opens up endless possibilities for your attendees. Davis County presents a wide variety of family adventure with four amusement centers, including Lagoon—the largest amusement park in the Intermountain West.

The Davis County Tourism Office can help your event succeed by providing services such as gathering proposals for accommodations and venues, coordinating off-site activities and transportation, acting as liaison to city and county government offices and much more. Call today and let us help make your event one to remember.



PlayInDavis.com

Davis County Tourism Office
 61 South Main Street, Suite 304
 Farmington, Utah 84025
 801-451-3237

Contents

- 1 Why Choose Davis County
- 2 Easy Access from SLC Airport
- 3 Transportation
- 4 Davis Conference Center
- 6 Legacy Events Center
- 8 Area Lodging
- 13 Area Lodging Map
- 14 Lagoon
- 15 Other Attractions
- 16 Antelope Island State Park
- 17 Recreational Activities
- 18 Davis County Golf
- 19 Skiing
- 20 Restaurants/Nightlife
- 21 Shopping

EASY ACCESS FROM SLC AIRPORT



▶ LODGING

- 1 Best Western CottonTree Inn
- 2 Motel 6
- 3 Comfort Inn (Woods Cross)
- 4 Hampton Inn (Farmington)
- 5 InTown Suites
- 6 Country Inn & Suites
- 7 Holiday Inn Express
- 8 Hampton Inn (Layton)
- 9 TownePlace by Marriott
- 10 Fairfield Inn
- 11 Courtyard by Marriott
- 12 La Quinta Inn
- 13 Hilton Garden Inn
- 14 Charin Inn
- 15 Days Inn
- 16 Best Western Plus
- 17 Comfort Inn (Layton)
- 18 Econo Lodge
- 19 Hampton Inn (Woods Cross)
- 20 Home2 Suites
- 21 Hyatt Place

▶ CAMPING

- 1 Pony Express
- 2 Lagoon RV Park
- 3 Cherry Hill Water Park
- ★ Antelope Island

▶ GOLF COURSES

- 1 Eaglewood
- 2 Bountiful Ridge
- 3 Lakeside
- 4 Swan Lakes
- 5 Glen Eagle
- 6 Schneider's Bluff
- 7 Sun Hills
- 8 Valley View
- 9 Davis Park
- 10 Crane Field

▶ CONVENTION CENTERS

- 1 Legacy Events Center
- 2 Davis Convention Center

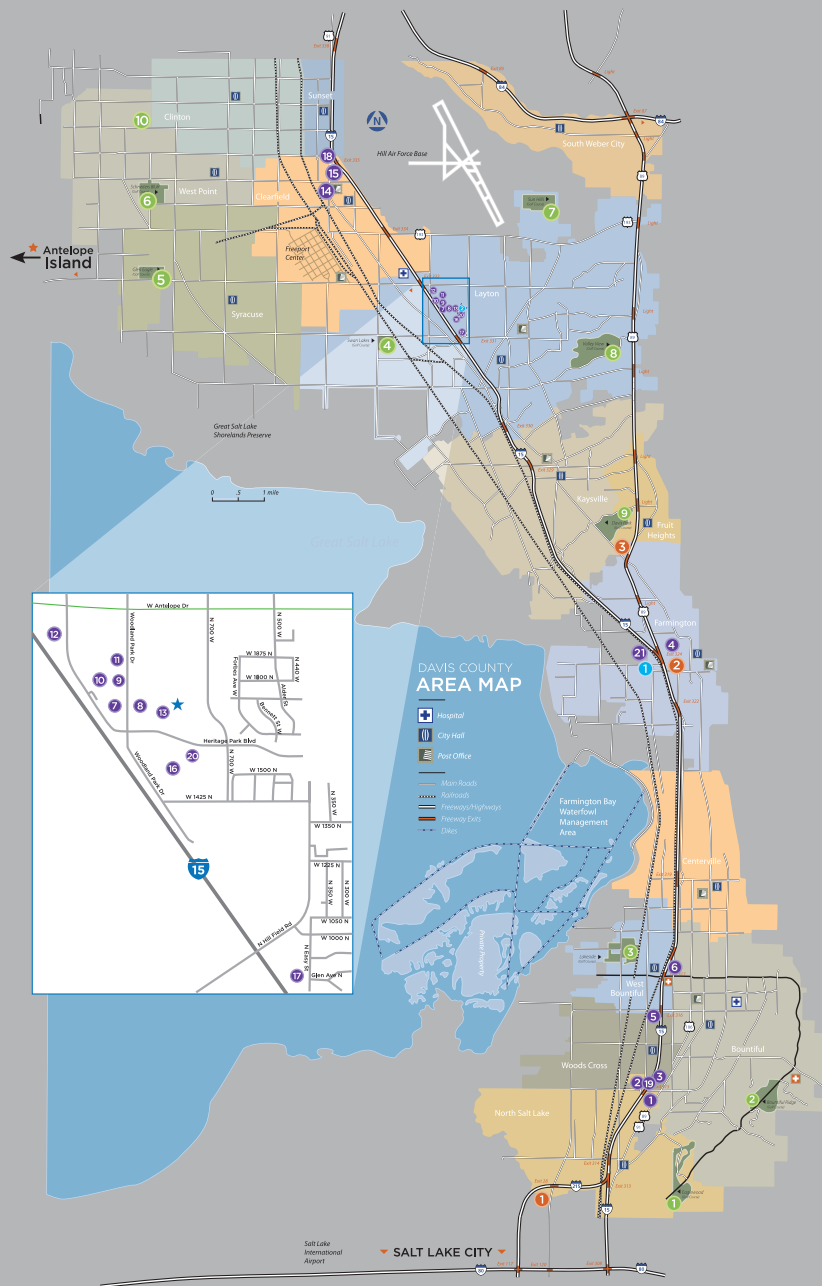

TRANSPORTATION

ALL RESORT GROUP

All Resort Group is Utah's largest private ground transportation provider with a brand legacy that dates back to 1914. Since the turn of this century, the company now provides all forms of wheels on the ground, with a 230-vehicle fleet that includes taxis, chauffeured sedans, SUVs and motorcoaches spread among Park City, Salt Lake City, Utah resort regions and Las Vegas, Nevada.

AllResortGroup.com



Traveling to Davis County is simple, convenient and easily accessible by road, rail and air. Interstates 15 and 80, U.S. Highway 89 and the Great Salt Lake Legacy Parkway Scenic Byway all access Davis County. The Salt Lake International Airport is within 10-25 minutes of any Davis County destination. The airport has approximately 600 arrivals and departures each day, connecting to over 90 non-stop destinations. Airlines currently serving SLC are: American Airlines, Alaska Airlines, Delta Air Lines, JetBlue Airways, Southwest Airlines and United Airlines.

The FrontRunner commuter rail system is easily accessible and affordable from Salt Lake City to Davis County and from the TRAX public transportation system from the airport. A variety of taxis, buses and shuttle companies are available to take you to your destination of choice. If you choose to drive to Davis County, the Davis Conference Center, the Legacy Events Center and all Davis County hotels offer complimentary parking.

DAVIS CONFERENCE CENTER



Experience Northern Utah's premier conference center for your next meeting, banquet, conference or tradeshow event. With over 70,000 square feet of flexible meeting space, the Davis Conference Center has everything you need to deliver a successful event at an affordable price. Amenities include the latest in electronic and internet technology with numerous LCD screen displays and projectors.

The Davis Conference Center is located off I-15 in Layton, Utah, just 20 minutes north of the Salt Lake International Airport. Additionally, Utah's FrontRunner commuter rail system is only minutes away. The Center is conveniently situated in the heart of Davis County's popular hospitality and restaurant district. A Hilton Garden Inn is attached to the Davis Conference Center and eight other major hotels are located within walking distance.

DavisConferenceCenter.com | 801-416-8888



Room Capacities	Total Sq Ft	Room Size
Aurora Board Room	730	36' x 20'
Fahrenheit Lounge	966	42' x 23'
Cirrus Atrium	1,318	45' x 29'
Cirrus Hall	2,088	87' x 24'
Convergence Hall	3,568	223' x 16'
Green Room	242	12' x 20'
Garden Grill	851	37' x 23'
Meridian Ballroom	12,459	174' x 71'
Meridian A	944	40' x 24'
Meridian B	2,808	39' x 71'
Meridian C	1,440	40' x 36'
Meridian D	1,274	35' x 36'
Meridian E	944	40' x 24'
Meridian F	944	40' x 24'
Meridian G	1,440	40' x 36'
Meridian H	1,558	43' x 36'
Sky Lobby	1,488	40' x 37'
Solstice Courtyard	9,100	70' x 130'
Twilight 1	519	17' x 30'
Twilight 2	1,062	35' x 30'

Room Capacities	Total Sq Ft	Room Size
Twilight 3	1,062	35' x 30'
Twilight 4	519	17' x 30'
Twilight Ballroom	3,162	107' x 30'
Zephyr	1,711	50' x 34'
Zephyr Hall	936	N/A
Business Center	63	7' x 9'
Eclipse Expo	18,360	153' x 120'
Eclipse Expo A	11,000	92' x 120'
Eclipse Expo B	7,440	62' x 120'
Eclipse Hall	1,430	110' x 13'
Eclipse/Stratus	24,993	N/A
Stratus Ballroom	6,752	88' x 86'
Stratus 5	1,272	38' x 38'
Stratus 6	1,089	38' x 28'
Stratus 7	1,074	37' x 28'
Stratus 8	1,101	37' x 28'
Stratus 9	1,096	37' x 28'
Stratus Corridor	1,120	86' x 13'
Horizon Lobby	3,293	64' x 50'
Horizon Hall	740	10' x 74'

LEGACY EVENTS CENTER



The Legacy Events Center, located in Farmington, Utah, is just 15 minutes north of Salt Lake City and conveniently located across the street from Station Park shopping plaza and the FrontRunner commuter rail system. The Legacy Events Center boasts breathtaking mountain views and excellent service. Amenities include a multi-use event center, adaptable exhibit building, 15 acres of playable grass and plenty of parking for any type of event. Whether you are holding a sporting event, national dog show, a meeting, trade show, family gathering or a regional horse show, our staff is ready to help your event succeed. Come create your legacy at the Legacy Events Center.

PlayInDavis.com/legacy-events-center | 801-451-4080

EVENTS CENTER HIGHLIGHTS

- Indoor Arena 36,000 sq. ft. floor space
- 2,200 permanent seating capacities (extra seating available)
- All indoor facilities climate controlled for year-round use
- 48 onsite RV hook-ups
- All facilities ADA accessible
- Onsite internet access
- Full-service concessions
- Over four acres of open groomed grass area for outdoor event use
- Outdoor vendor pad in grass area with electricity and water
- 11.2 acres containing four college-sized soccer fields
- Banquet facilities (up to 300 people)
- In-house catering available
- 1,400 paved parking stalls

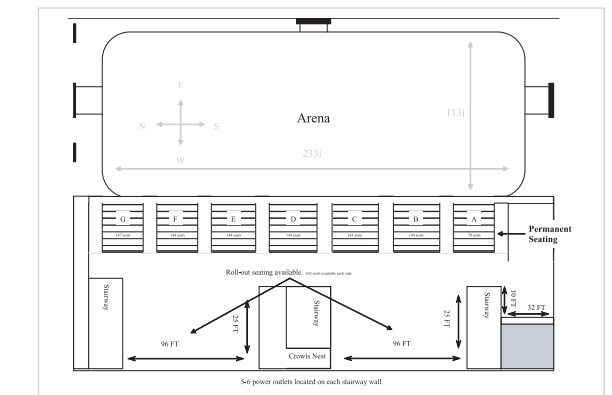
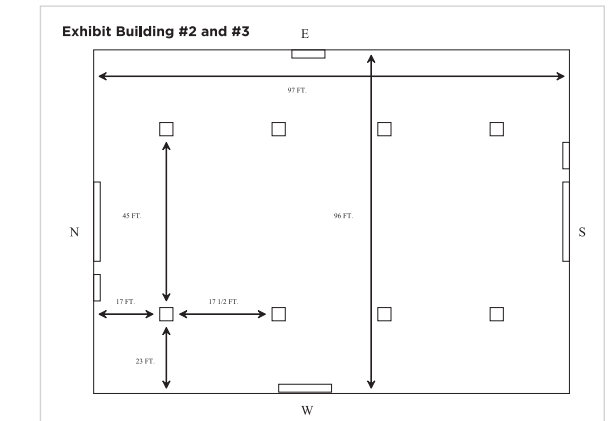
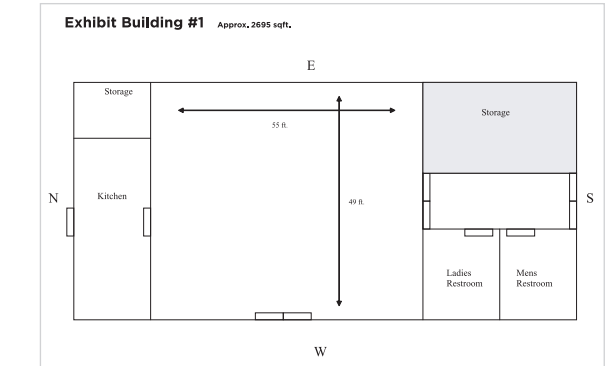
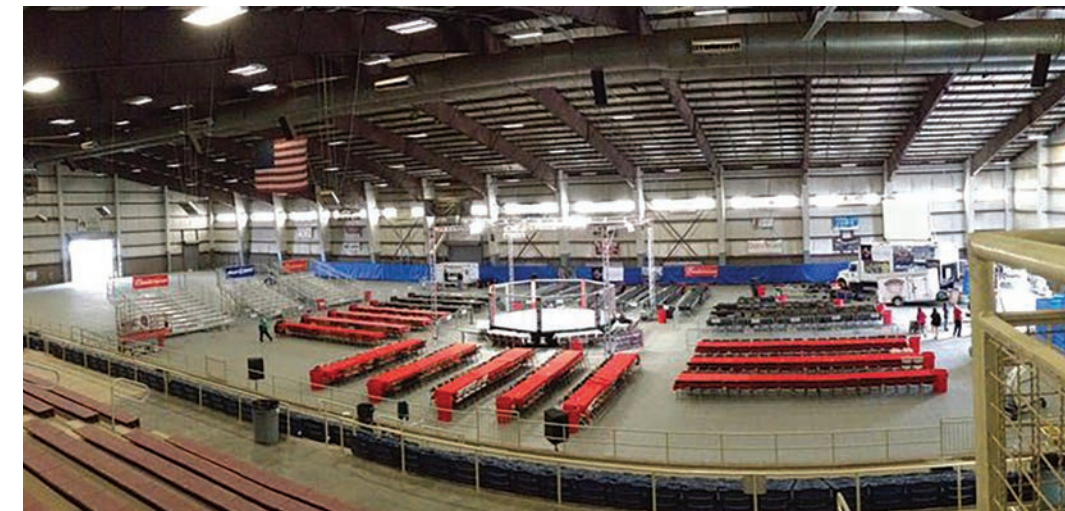

AREA LODGING



BEST WESTERN COTTONTREE INN
1030 N. 400 East, North Salt Lake, UT 84054
801-292-7666 www.bestwestern.com

Located minutes from downtown Salt Lake City and SLC Airport. Complimentary transportation to and from the airport. Newly renovated hotel features a free, full hot breakfast, pool, fitness center, meeting rooms and bus parking. Pets allowed. Close to Legacy Events Center and Lagoon amusement park for special events, meetings and family fun. Conveniently located near downtown Salt Lake shopping, LDS Temple Square and the Salt Palace Convention Center.



BEST WESTERN PLUS
798 W. 1425 North, Layton, UT 84041
801-896-0271 www.bwlaytonpark.com

Great location right off I-15 and within close proximity of Hill Air Force Base and the Davis Conference Center. It's easy to get around the area. Enjoy skiing in the winter, year-round shopping at the local malls or all-day fun at Lagoon amusement park. Hotel features include high-speed internet, complimentary breakfast, indoor pool, fitness center, restaurant onsite and hot tub. 100% no-smoking.



CHARIN INN
116 N. Main Street, Clearfield, UT 84015
801-825-2221

Privately owned and centrally located off I-15 for those guests wishing to sightsee in the area. Provides 24-hour reception desk service, as well as free parking and ski lockers. Pets are welcome. Rooms are comfortable and offer kitchenettes that are equipped with microwave ovens. Entertainment options include a TV and internet. Salt Lake City International Airport is a 35-minute drive from the hotel.



COMFORT INN & SUITES-WOODS CROSS
2437 S. Wildcat Way, Woods Cross, UT 84010
801-298-3900 www.choicehotels.com/utah/woods-cross/comfort-inn-hotels/ut080

Close to Eaglewood Golf Course and Bountiful Ridge Golf Club. Make yourself at home in one of our 78 guestrooms featuring refrigerators and microwaves. Complimentary wireless internet access keeps you connected and cable programming is available for your entertainment. Conveniences include desks and coffee/tea makers, indoor pool and spa tub, complimentary buffet breakfast, business center, computer station and dry cleaning/laundry services. Meeting rooms available. Pet friendly.



COMFORT INN LAYTON
877 N. 400 West, Layton, UT 84041
801-544-5577 www.choicehotels.com/utah/layton/comfort-inn-hotels/ut065

Amenities include free wireless high-speed internet access, free local calls, indoor heated pool, fitness center, guest laundry facilities and business center. Guest rooms feature expanded cable television channels, coffee makers, hair dryers, microwaves and refrigerators. Non-smoking rooms are available. Enjoy free hot breakfast. Pet friendly.



COUNTRY INN & SUITES BY CARLSON
999 N. 500 West, Bountiful, UT 84010
801-292-8100 www.countryinns.com/bountiful-hotel-ut-84010/utwestb

Guests are treated to an impressive array of services like a refreshing indoor pool and a well-equipped fitness center. Conveniently located near numerous attractions like the Salt Palace Convention Center and Temple Square, plus local area and airport shuttle service available for a minimal fee. Guests will enjoy free high-speed internet access, meeting facilities and a complimentary hot breakfast buffet. Reserve your gracious room or suite today! 100% non-smoking facility.



COURTYARD BY MARRIOTT
1803 Woodland Park Drive, Layton, UT 84041
801-217-2300 www.marriott.com/slcl

New state-of-the-art lobby featuring flexible spaces to work in or relax, complimentary Wi-Fi throughout and easy access to the latest news, weather and airport conditions via our GoBoard. The highlight of our new lobby experience is the Bistro "Eat-Drink-Connect." Other features include a 24-hour fitness center, renovated meeting rooms and Executive Boardroom-featuring over 3,000 square feet of space, indoor pool and spa and outdoor patio next to the fire pit.



DAYS INN
572 N. Main Street, Clearfield, UT 84015
801-825-8000 www.daysinn.com/hotels/utah/clearfield/days-inn-clearfield/hotel-overview

Conveniently located off I-15 between Ogden and Salt Lake Metro area. Our hotel offers a free continental breakfast, free Wi-Fi internet access up to 25Mbps, onsite fitness center and guest laundry. Jacuzzi suites and handicapped-accessible facilities, plus non-smoking rooms are also available. Kids 17 and under stay free with an adult. Pet friendly.



ECONO LODGE
815 N. Main Street, Clearfield, UT 84015
801-825-9500 www.choicehotels.com/utah/clearfield/econo-lodge-hotels/ut154

Conveniently located off I-15, with easy access to Hill Air Force Base, Hill Aerospace Museum and great restaurants. Hotel amenities include free continental breakfast, handicap parking and rooms accessible to individuals with disabilities, phones for hearing impaired, copy and fax machines, guest laundry, high-speed internet, microwave, refrigerator and kitchen facilities in some rooms.



FAIRFIELD INN BY MARRIOTT

1740 Heritage Park Boulevard, Layton, UT 84041

801-444-1600 www.marriott.com/hotels/travel/slclly-fairfield-inn-salt-lake-city-layton

Located in the heart of Layton's retail and hospitality district. Features 77 rooms with well-lit work desks, mini fridge, microwave, indoor pool and heated spa, laundry room, complimentary hot continental breakfast, free cable with HBO, fitness center and free high-speed Wi-Fi internet access in every room. To make things easier for the business traveler, free connect-and-print boarding pass services are available. 100% non-smoking environment.



HAMPTON INN LAYTON

1700 Woodland Park Drive, Layton, UT 84041

801-775-8800 www.saltlakecitylayton.hamptoninn.com

Step outside the high-energy pace of Salt Lake City—but stay within easy reach—when you visit Layton, a peaceful suburb just north of Salt Lake City. Enjoy great amenities such as indoor swimming pool, hot tub, a gym/fitness center, free hot breakfast and free high-speed internet access in every room. Catch up with work in the well-equipped business center, or print last-minute boarding passes at any time. Pet friendly.



HAMPTON INN & SUITES SALT LAKE CITY/FARMINGTON

332 W. Park Lane, Farmington, UT 84025

801-451-7999 www.farmingtonutsuites.hamptoninn.com

Across from Lagoon amusement park and one block from Station Park—Northern Utah's premier shopping and dining center. Hotel amenities include 83 beautifully-designed state-of-the-art rooms, high-speed wired/wireless internet, free breakfast, meeting rooms, indoor pool/hot tub, business center, fitness center, 42" flat screen HDTVs with all HD channels, microwave/fridge in all rooms, guest laundry, jacuzzi plus executive & family suites. Pet friendly. 100% non-smoking facilities. UTA shuttle service available to Lagoon and Station Park shopping center.



HAMPTON INN WOODS CROSS

2393 S. 800 West, Woods Cross, UT 84087

801-296-1211 www.hamptoninn3.hilton.com/en/hotels/utah/hampton-inn-salt-lake-city-north-SLCNOHX/index.html

Conveniently located off I-15 between Ogden and Salt Lake Metro area. Our hotel offers a free continental breakfast, free Wi-Fi internet access up to 25Mbps, on-site fitness center and guest laundry. Jacuzzi suites and handicapped-accessible facilities, plus non-smoking rooms are also available. Kids 17 and under stay free with an adult. Pet friendly.



HILTON GARDEN INN

762 W. Heritage Park Boulevard, Layton, UT 84041

801-416-8899 www.layton.gardeninn.com

Located just 20 minutes north of Salt Lake City and SLC Airport. Has 147 rooms and suites making it the largest hotel in Davis County. Connected to the Davis Conference Center. Designed for the business traveler and the weekend leisure guest. Room amenities include high-speed internet, remote printing to the business center, refrigerator, microwave, coffeemaker, large desk work area, two dual-line speakerphones, on-demand movies and HBO. Features a full-service grill, private club, pool and pantry.



HOLIDAY INN EXPRESS

1695 Woodland Park Drive, Layton, UT 84041

801-773-3773 www.laytonexpress.com

Designed to meet the needs of every traveler. For our business-minded clients, we offer a boardroom with seating for eight, a meeting room for 40 people, a Business Center and free Wi-Fi access throughout the hotel. Cozy, smoke-free environment. Swim laps in an indoor pool, relax in the hot tub or work out in the fitness center. Every morning features a free, hot Express-Start breakfast bar; and three times a week, we serve appetizers and beverages at our hotel's Manager's Reception.



HOME2 SUITES

803 Heritage Park Boulevard, Layton, UT 84041

801-820-9222 www.hilton.com/search/ht/us/ut/layton

Stylish studio suites that offer extended stay with full kitchens, coin-operated laundry, cribs and playpens, complete fitness center, indoor pool and hot tub, free breakfast and high-speed internet. Pet friendly. Close to Hill Air Force Base and Davis Conference Center.



HYATT PLACE

222 N. Union Avenue, Farmington, UT 84025

801-683-4444 www.place.hyatt.com

The Hyatt Place is conveniently located 25 minutes from the Salt Lake City Airport just off of I-15. This hotel is unique in that it is connected to the Shops at Station Park. Hotel amenities include complimentary Wi-Fi, complimentary breakfast, 24-hour fitness center, indoor pool and jacuzzi and a library with an outdoor deck. The Hyatt Place has an intimate bakery cafe, cocktail bar and a 24/7 guest kitchen serving made-to-order entrees and snacks. Pet friendly.



INTOWN SUITES

635 S. 700 West, Woods Cross, UT 84087

801-296-6400 www.intownsuites.com

Not a hotel, but extended stay apartment-style living at extremely low weekly rates. Feel right at home with furnished apartment amenities. All utilities are included, and there are no deposits for water, gas, electric, cable/satellite or internet service. We provide everything! No lease required, it's easy to come and go as your needs change. No credit check, no contract! Your short-term housing solution.



LA QUINTA INN & SUITES

1965 N. 1200 West, Layton, UT 84041

801-776-6700 www.laquintalayton.com

Conveniently located just 30 minutes north of downtown Salt Lake City and minutes from Hill Air Force Base. Adjacent to I-15. Offers a free hot breakfast, free Wi-Fi and flat-panel TV with HD programming, indoor swimming pool and complete fitness center. Added features include meeting facility, morning newspaper, laundry room and free parking. Pet friendly.



MOTEL 6

2433 S. 800 West, Woods Cross, UT 84087
 801-298-0289 www.motel6.com

Promises to be the lowest price of any national chain and is synonymous with quality and value. Clean, comfortable rooms are virtues of this hotel brand which is the largest owned and operated hotel chain in North America. Amenities include free local phone calls, morning coffee, expanded cable TV, kids stay free (17 and under), non-smoking rooms available, outdoor pool and guest laundry. Pet friendly.



TOWNEPLACE SUITES BY MARRIOTT

1743 N. 1000 West, Layton, UT 84041
 801-779-2422 www.marriott.com/hotels/travel/slctl-towneplace-suites-salt-lake-city-layton

For extended-stay travelers offering both studio and one- and two-bedroom suites, with fully equipped kitchens and a work area with a desk. Amenities also include an outdoor pool and barbecue area along with a 24-hour fitness room, free breakfast, separate voice and data phone lines, on-site business center and a 24-hour coin-operated laundry. Pet friendly.



AREA LODGING MAP

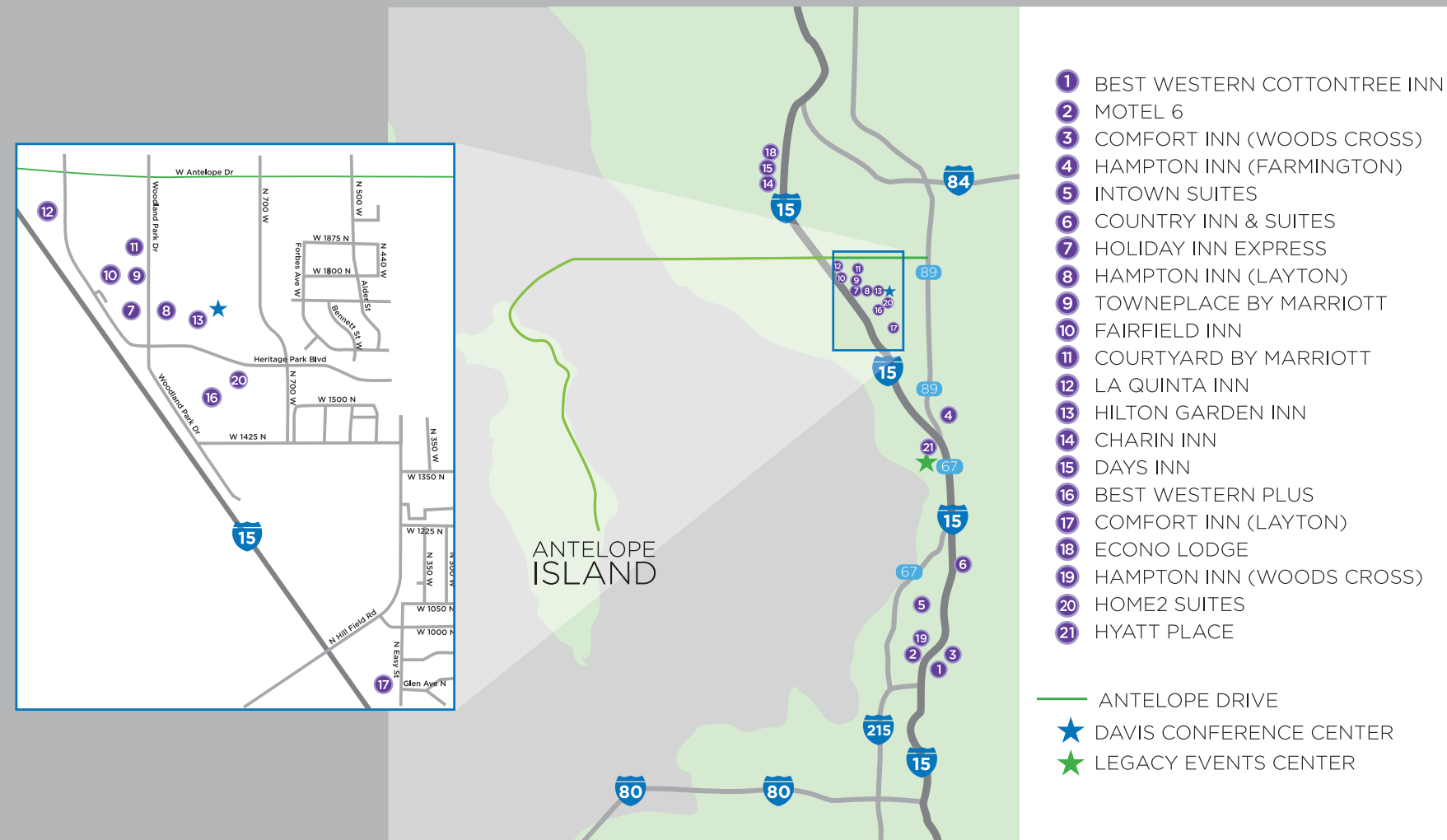

LAGOON



America's largest family owned amusement park located in Farmington, Utah, is just 15 miles north of Salt Lake City. Lagoon has over 55 rides and attractions, including Lagoon-A-Beach waterpark, historic Pioneer Village and Cannibal—a thrilling mega coaster that lifts riders 208 feet and plunges them into a 116° beyond vertical free-fall. Corporate groups get great discounts on single day passports, catering, picnic facilities and much more.

LagoonPark.com | 801-451-8000

OTHER ATTRACTIONS

BOONDOCKS FOOD & FUN

A group outing at Boondocks Food & Fun is the easy and affordable way to bring together your family, friends, coworkers or your company's best clients.



Learn more at PlayInDavis.com/Amusement-Centers

CHERRY HILL

Located in Kaysville, Utah, Cherry Hill offers a wide variety of activities for the whole family, including water slides, pools, mini golf, rock climbing and more.



THE RUSH

The Rush funplex in Syracuse, Utah offers fun for any size group. The largest indoor amusement center in Utah offers bowling, mini golf, laser tag, arcades and more.



ANTELOPE ISLAND STATE PARK



Located in the middle of the Great Salt Lake, you'll find Antelope Island State Park. Within the park's beautiful 28,000 acres, you can enjoy time at the beach, float in salt water or discover over 40 miles of breathtaking trails for hiking, biking and horseback riding. Bring binoculars for the best viewing of antelope, mule deer, bighorn sheep, coyotes and a herd of over 500 free roaming bison.



ANTELOPE ISLAND ACTIVITIES

Come experience this natural environment of wildlife and spectacular sunsets. Visit Fielding Garr Ranch, the Visitor Center or just discover the area on your own. For more information, contact the Antelope Island Visitor Center at 801-725-9263 or visit PlayInDavis.com/antelope-island-state-park-great-salt-lake



R & G HORSE AND WAGON, LLC

Guided horseback rides can be tailored for wildlife viewing, geology or bird watching. Reservations suggested.
801-726-9514 RandGHorseAndWagon.com

GONZO BOAT RENTALS & TOURS

Sunset dinner cruises, kayaks, paddle boards and more.
801-989-7281 GonzoFun.com

RECREATIONAL ACTIVITIES



CULTURAL ARTS

Davis County offers many different opportunities to experience culture and arts, with activities such as outdoor concerts at the Ed Kenley Amphitheater, theatrical plays at Centerpoint Legacy Theatre, art exhibits at the Bountiful Davis Arts Center or even viewing vintage aircraft at Hill Aerospace Museum.



BIRDING

Davis County repeatedly wins acclaim as a top birding and wildlife-viewing destination. Millions of birds visit or nest in the Great Salt Lake wetlands annually. Don't miss the annual Great Salt Lake Bird Festival held in May for a birds-eye view.

Learn more at GreatSaltLakeBirdFest.com



HIKING AND BIKING

The trail system in Davis County offers hikers and bikers everything from easy to very challenging terrain. The one common theme is spectacular scenery and natural beauty.



- Bonneville Shoreline Trail (19.75 miles)
- Kays Creek/Great Western (2.8 miles)
- Adams Canyon/Bonneville Shoreline Trail (3.5 miles)
- Webb Canyon Trail/East Mountain Wilderness Park (3 miles)
- Baer Creek Trail (9.5 miles)
- Parrish Creek/Bonneville Shoreline Trail (4.8 miles)
- Holbrook Canyon Trail (3.3 miles)
- Mueller Park Trail (13 miles)
- North Canyon Trail (3.6 miles)
- Antelope Island State Park (36 miles)
- Scenic Drive - Farmington Canyon Scenic Backway. The scenic route is comprised of three Wasatch-Cache National Forest roads.

Visit daviscountyutah.gov/trails for directions and more information

DAVIS COUNTY GOLF



Davis County delivers both scenic beauty and an enjoyable challenge to the golf enthusiast. The diverse variety of our 10 pristine courses provides golfers of every skill with an unforgettable experience. Contact courses directly for great tournament ideas and rates.



NAME	WEBSITE	PHONE NUMBER
Bountiful Ridge	www.bountifulridgegolf.com	801-298-6040
Crane Field	www.remudagolf.com	801-779-3800
Davis Park	www.davisparkutah.com	801-544-0401
Eaglewood	www.eaglewoodgolf.com	801-299-0088
Glen Eagle	www.golfgleneagle.com	801-773-4653
Lakeside	www.lakesidegolfcourse.com	801-295-1019
Schneiter's Bluff	www.schneitersgolf.com	801-773-0731
Sun Hills	www.sunhillsgolf.com	801-771-4814
Swan Lake	www.swanlakesgolf.com	801-546-1045
Valley View	www.valleyviewutah.com	801-546-1630

SKIING



SKI THE GREATEST SNOW ON EARTH

Once you've tried skiing or snowboarding in Utah, you'll have joined millions who have experienced the greatest snow on earth. The resorts offer everything from family skiing to black diamond adventures. Take advantage of the nine different ski resorts located just 25-60 minutes away from Davis County. Snowbasin and Powder Mountain are located to the north and Snowbird, Solitude, Alta, Brighton, Park City and Deer Valley are to the south.



SKI RESORTS

RESORT	WEBSITE	AVERAGE SNOWFALL	NUMBER OF RUNS
Alta	www.alta.com	560"	116
Brighton	www.brightonresort.com	500"	62
Deer Valley	www.deervalley.com	300"	101
Park City Mountain	www.parkcitymountain.com	360"	324
Powder Mountain	www.powdermountain.com	500"	154
Snowbasin	www.snowbasin.com	300"	104
Snowbird	www.snowbird.com	500"	168
Solitude	www.skisolitude.com	500"	77
Sundance	www.sundanceresort.com	300"	45

SNOWBASIN

Snowbasin Resort—the closest resort to Davis County—combines 3,000 acres of world-class skiing with luxurious lodges and amenities. The resort opened in 1940 and is one of the oldest operating ski areas in the United States. It proudly hosted the 2002 Olympic Winter Games' Downhill, Combined and Super-G races.

Snowbasin Resort's uncrowded slopes offer adventure seekers of all abilities wide open bowls, steep chutes, evergreen-forested gullies and beautiful, long rolling groomers. The resort's majestic lodges feature stunning views, grand fireplaces and marble finishes. Snowbasin Resort's award-winning dining is consistently rated in the top three by Ski Magazine and features a variety of cuisine from locally-sourced ingredients in their five slopeside restaurants.

- 3,000+ acres of skiable terrain
- 104 runs, 20% beginner, 50% intermediate, 30% advanced
- 12 lifts, including two high-speed gondolas and a tram
- 2,950 vertical feet

RESTAURANTS/NIGHTLIFE

Davis County has over 400 restaurants. There are over 60 restaurants alone in the hotel district surrounding the Davis Conference Center. We've listed some of our unique restaurants and a full list of the Davis County restaurants and their locations can be found on PlayInDavis.com.



CORBIN'S GRILLE

Step into the newly renovated Corbin's Grille and surprise your taste buds with a culinary fusion. Enjoy a combination of modern, western food—think steak and potatoes—with a subtle hint of Italian and French tastes.

FAHRENHEIT LOUNGE

Fahrenheit Lounge has a modern-retro, rat-pack environment, with white leather couches, glistening, smoky chrome bar and metropolitan abstract artwork. The outside lounge and fire pit are the perfect way to enjoy the warm summer nights after meetings.

ROOSTERS BREWING COMPANY

Roosters is Davis County's first micro-brewery. They offer full liquor service and have more than 26 unique beers. Roosters serves an exciting assortment of flavorful pizzas, pastas and delicious entrees and appetizers.

MANDARIN

Mandarin has been family owned and operated for 38 years, and serves memorable wok-prepared dishes using top-quality vegetables, meat and seafood. Banquet facilities are available for groups of 50-200 (lunch) or 8-50 (dinner).

SILL'S CAFÉ

You won't want to miss Sill's Café in Layton if you like going to the restaurants where the locals go. This family owned café offers amazing breakfast items such as their famous giant scones and pancakes. As a local favorite, Sill's Café definitely won't disappoint.

SHOPPING

STATION PARK

Station Park is an upscale, open-air, mixed-use lifestyle center in Farmington, Utah, located 15 miles north of Salt Lake City. The 62-acre property sits adjacent to the UTA commuter rail station, I-15, Highway 89 and the Legacy Parkway. Station Park houses signature restaurants, national and local retail establishments, entertainment venues and Class-A office space.

The heart of Station Park is Fountain Square. Strategically placed to the north of Cinemark theaters, Fountain Square includes a world-class water feature, a beautiful event lawn, outdoor fireplace, shaded patios and a woodland children's play area. When a quick bite is desired, look no further than the six gourmet eateries located in the two pavilions east and west of Fountain Square.

LAYTON HILLS MALL

Layton Hills Mall is the premier shopping mall in Layton, Utah. The mall is anchored by Macy's, JCPenney and Dick's Sporting Goods, and features more than 80 of your favorite stores and restaurants, as well as Tinseltown 17 movie theater.

PlayInDavis.com/places-to-play/categories/shopping





Davis County Tourism Office / 61 South Main Street, Suite 304, Farmington, Utah 84025 / 801-451-3237

PlayInDavis.com